



AKAA TENT
& SHADES LLC

AL KHAYAM AL ARABIAH
TENTS AND SHEDS TRD LLC



COPYRIGHT 2017

These pages contain information about material that is protected by copyright laws.

No part of this brochure may be copied, duplicated or communicated in any form or by means, electronic or mechanical, including photocopying, facsimile or by any such like systems without permission of the publishers.

All rights reserved.

We reserve the right to make alterations without notifications.

AL KHAYAM AL ARABIA TENTS AND SHED TRD LLC



AL KHAYAM AL ARABIAH

TENTS AND SHEDS TRD. LLC

Company Profile

About us:

We are Sharjah based company dealing in manufacturing and supply of tents for sales and rentals. One of our major works is the manufacturing, fabrication and installation of all kinds of tents, Car parking sheds, canopies for doors and windows. Al Khayam Al Arabia Tents and Parking Shades Trading LLC Sharjah applies the latest technology and the best practices in developing environment-friendly products. We manufacture products with the essential support of the design and engineering department, which creates and develops exclusive modern designs for. Al Khayam Al Arabia Tents and Parking Shades Trading LLC Sharjah factory is fully well-equipped with German-made machineries and with the world's state-of-the-art technologies, giving us an edge to always manufacture and produce high-quality products for our valuable customers. Al Khayam Al Arabia Tents and Parking Shades Trading LLC Sharjah is the only manufacturing company in UAE Sharjah which provide after sale services and customer care center. We are specialized in Tents structure manufacturing, sale & Rental solution.

History:

Al Khayam Al Arabia Tents and Parking Shades Trading LLC Sharjah was established in 1982 and Located in Sharjah industrial zone U.A.E it is the sister company of AL Khayam Tents Industry LLC and also a sister company of Empire Marquee Pvt Ltd located in Pakistan.

Vision:

Our vision is to satisfy customers by building transparent business, trust, loyalty and using the best strategy as i.e. A Satisfaction of our customer is the best business strategy of all and Our success stories demonstrate the trust of clients have in our capabilities to reinvent business & Enhance costs a trust that is vindicate by result.

Mission:

Excellence in fulfilling the commitments made to clients Uncompromising commitment to the quality of work.
Developing visibility to generate new business leads.
Timeous response to client's orders.
Successful Marketing.

Why choose us?



TENTS AND SHADES

AKAA Tents and Shades L.L.C utilize the finest tools and techniques for tents and Shades manufacturing.



FORWARD THINKING

AKAA is a great, forward thinking Tents & Shades manufacturing company in UAE and its nice to serve its services to its clients.



PROBLEM SOLVERS

AKAA Tents and Shades LLC is available here for you any time and provide best tents and shades services.



CUSTOMER SUPPORT

We take care of our beloved Customer's needs by delivering professional and high quality services.

A renowned leading U.A.E- based manufacturer of marquee tents systems and industrial steel building. A wide range of over 200 different temporarily structure systems for multiple applications. State-of-the-art production facilities able to produce up to the 10000 m2 of new structure per week. Components are finished by state of the art machine and by hand ensuring a consistent high quality finish.

Dedicated, assisted by skilled professionals, the technical team of cad designs and engineer for custom projects. European Standards guarantee high quality professional engineer and fully certified structures Competitive pricing policy across all product lines-ensuring customer satisfaction.

License and Certificates:

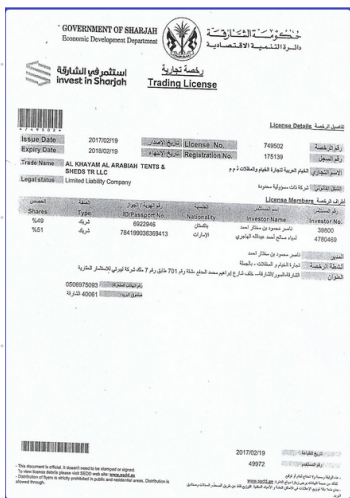

TRADE LICENSE

AL Khayam Al Arabiah Tents and Sheds Trd L.L.C
Licence No : 749502 | Registration No : 175139
Issue Date : 2017/02/19 | Expiry Date : 2018/02/19



MEMBERSHIP REGISTRATION CERTIFICATE

Membership Registration Certificate for year 2017 Sharjah Chamber of commerce and Industry according to the law no (1) 2003.



CERTIFICATE SHARJAH POLICE STATION

General Directorate of Police Operations
Comprehensive Police Station Dept.
Industrial Areas Comprehensive Police Station.



CERTIFICATE SHARJAH POLICE STATION

General Directorate of Police Operations
Comprehensive Police Station Dept.
Industrial Areas Comprehensive Police Station.

Our Clients

Our passion, creativity, and meticulous attention to detail and total commitment to customer satisfaction has earned us the business of a number of the world's leading brands. The following list is our portfolio featuring only a few of our clients

- Al Fahim Group
- Al Hamra Construction LLC
- Al Naboodah Contracting LLC
- Dubai Design District FZ LLC
- Dillenger Middle East FZE
- Dubai Equestrian Club
- GE Water & Process Technologies ME FZE
- Highgrand Services General Contracting LLC
- Pravarthi Building Contracting LLC
- York General Contracting LLC
- Nad Al-Shiba Real Estate
- Citiscape
- ECC Engineering Contracting Co. LLC
- Fibrex Contracting
- Marwan General Contracting Co. LLC
- Mubarak Mathar Insulatin Cont.
- Nestle Waters Factory H&O LLC
- One & Only Royal Mirage
- Fun Corner LLC
- Gargash Enterprizes
- Skm Airconditioning Equipment
- Al Khaleej Sugar Co. LLC
- Gulf Petromechanical
- Universal Modem Tents
- Al Yateem Group
- Dahbashi Engineering
- Al Jabar Group
- Tekom Global Village
- Danube Build Mart
- Harsha Engineering & Cont. Co
- Pharmalink
- Newline Interiors
- Medpharma
- Ascanadian Insurance Co.
- Pharmatrade
- Intersal Dowding & Mills Co.
- Al Fakhar Tobacco
- Civil Defence Dubai
- Hyundai
- Credence Technical Surveyors
- S.S. Switch Gear
- Eastern Motors
- Inkas (Saif Zone)
- Civil Defence
- Developer Building Cont.
- M.Tech Contracting LLC
- Geo Chem
- Preference Foundation Cont. Co
- Emirates Float Glass Compnay
- Arabic Automatic Doors
- Clipsal
- Highgate Interiors
- Peirlite
- Consolidated Shipping Services
- Al Qasmia Hospital Sharjah
- Kingdom Hotel
- Five Brothers General Trdg. LLC
- Al Ittihad Private School
- Al Nasia General Cont. Co
- ENOC
- Tetra Gulf
- Valtrans

Machine and Tools

- VC WELDING MACHINE
- METRE MOVING TYPE.
- PVC WELDING MACHINES STILL TYPE
- PVC WELDING MACHINES 20
- METRE MOVING TYPE
- PVC WELDING MACHINES STILL TYPE
- SANDBLASTING MACHINE.
- SANDBLASTING MACHINE.
- CABIN TYPE
- CNC ALUMINUM CUTTING MACHINE
- CNC PROFILE CUTTING MACHINE
- CNC MARKING MACHINE
- CNC HEAD MAN MACHINING
- CNC HEAD MAN LATHE MACHINE
- CENTRE VMC-540
- BAR THREADING MACHINE
- MANUAL LATHE MACHINE
- LATHE MILL COMBO
- UNIVERSAL TOOL GRINDER
- MANUEL DRILL MACHINE
- DRILL AND FRASING MACHINE
- ALUMINUM CUTTING SAW
- DISC CUTTING MACHINE
- PNEUMATIC TAPPING MACHINE
- MANUEL GRINDER
- GRIGGIO GA 630
- GRIGGIO PF 510
- GRIGGIO T 220
- SPINDLE MOULDER
- PS 53 THICKNESSING MACHINE
- LIFTING JACK
- HEAVY DUTY JACK
- BATTERY CHARGER
- CONCRETE DISC CUTTING
- MACHINE
- VACUUM CLEANER SMALL
- VACUUM CLEANER HEAVY DUTY
- LOADING CRANE TRUOVERY TRUCK
- BOOM LIFTING CRANES
- SCISSOR LIFT TRUCK
- UNIVERSAL IRON WORKER
- 5 MANUAL PALLET JACKS.
- IRON BENDING MACHINE
- REABER TYING MACHINES.
- HILTI DRILL MACHINE
- HAND GRINDER
- HAND DRILLS
- MANUEL DISC CUTTING
- MAGNET DRILL
- JIG SAW



OUR TENT PRODUCTS

- Pagoda Tent
- Pinnacle Tent
- Gazebo Tent
- Arcum Tent
- Polygon Tent
- A-Shape Tent
- Multi-side Tent
- Curve Tent
- High Peak Tent
- Wedding Tent
- Warehouse Tent
- Dome Tent
- Military Tent
- Cube Structure Tent
- Steel Structure Tent

PAGODA TENT



Tent Details :

Pagoda Tent Very suitable for small gatherings, birthday parties and various parties. We tarp is waterproof fire of PVC material, rainy weather can be used even in the water will not flow into the inner tent. Independent house structure, shape looks nice, like a little house to move, galvanized iron pipe brackets to support, stable and durable. And unlimited space and can be installed in small private courtyard garden. Grass, cement and so can. Wind Load Capability is 80 Km/h (0.3kn/m2)

Material and Fabrication

Aluminum Alloy Main Profile, Floor System, Glass Door, Glass wall, PVC Roof Cover, Ground Anchors, Sidewalls with PVC Fabric, Lining Curtains, Double Wing Glass Door, Rain Gutters, Decoration ceilings and Inside curtain.

Specifications of Roof & Side wall:

PVC: 0.46mm thickness PVC, 580 - 900 GSM, Fire retardant to DIN 4102 B1, M2, Water proof, UV protection



Tent Sizing

3M X 3M, 4M X 4M, 5M X 5M, 6M X 6M, 8M X 8M, 10M X 10M, Modify as per Request

Span Width	Eave Height	Ridge Height	Main Profile
3m / 4m / 5m / 6m / 8m / 10m /	2.5m / (For 3-6m) 2.6m (For 8m, 10m)	4.3m / 4.8m / 5.43m / 5.92m / 5.36m / 6.38m /	65x65x2.5mm (for 3-6) 122 x 68 x 3mm (for 8m, 10m)



PINNACLE TENT



Tent Details :

The Pinnacle tent is more easier to assemble and dismantle as well as easier to store. We tarp is waterproof fire of PVC material, rainy weather can be used even in the water will not flow into the inner tent. Independent house structure, shape looks nice, like a little house to move, galvanized iron pipe brackets to support, stable and durable. And unlimited space and can be installed in small private courtyard garden. Grass, cement and so can. Wind Load Capability is 80 Km/h (0.3kn/m2)

Material and Fabrication

Aluminum Alloy Main Profile, PVC Roof Cover, Ground Anchors, Sidewalls with PVC Fabric, Lining Curtains, Double Wing Glass Door, Rain Gutters, Decoration ceilings and Inside curtain.

Specifications of Roof & Side wall:

PVC: 0.46mm thickness PVC, 580 - 900 GSM, Fire retardant to DIN 4102 B1, M2, Water proof, UV protection



Tent Size

3M X 3M, 4M X 4M, 5M X 5M, 6M X 6M, 8M X 8M, 10M X 10M, Modify as per Request

Span Width	Eave Height	Ridge Height	Main Profile
3m / 4m / 5m / 6m /	2.5m	43.98m / 4.58m / 5m / 5.43m /	65 x 65 x 2.5mm (for 3-6)

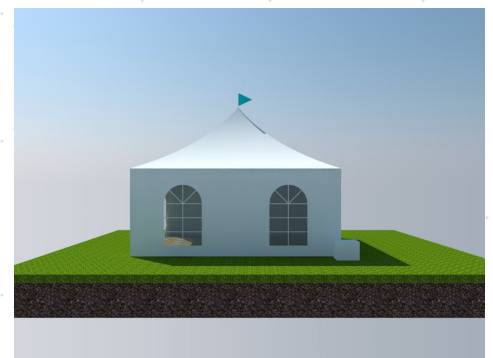
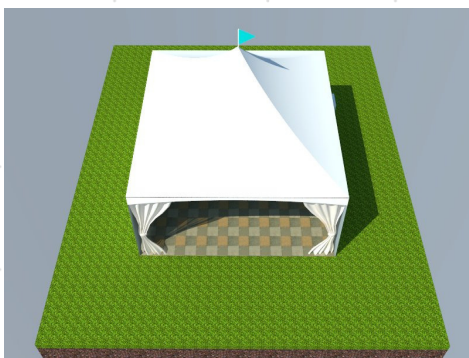

GAZEBO TENT



Tent Details :

The Gazebo Tent is more easier to assemble and dismantle as well as easier to store. We tarp is waterproof fire of PVC material, rainy weather can be used even in the water will not flow into the inner tent. Independent house structure, shape looks nice, like a little house to move, galvanized iron pipe brackets to support, stable and durable. And unlimited space and can be installed in small private courtyard garden. Grass, cement and so can. Wind Load Capability is 80 Km/h (0.3kn/m2)

Material and Fabrication

Aluminum Alloy Main Profile, PVC Roof Cover, Ground Anchors, Sidewalls with PVC Fabric, Lining Curtains, Double Wing Glass Door, Rain Gutters, Decoration ceilings and Inside curtain.

Specifications of Roof & Side wall:

PVC: 0.46mm thickness PVC, 580 - 900 GSM, Fire retardant to DIN 4102 B1, M2, Water proof, UV protection



Tent Size

3M X 3M, 4M X 4M, 5M X 5M, 6M X 6M, 8M X 8M, 10M X 10M, Modify as per Request

Span Width	Eave Height	Ridge Height	Main Profile
3m / 4m / 5m / 6m /	2.5m	43.98m / 4.58m / 5m / 5.43m /	65 x 65 x 2.5mm (for 3-6)

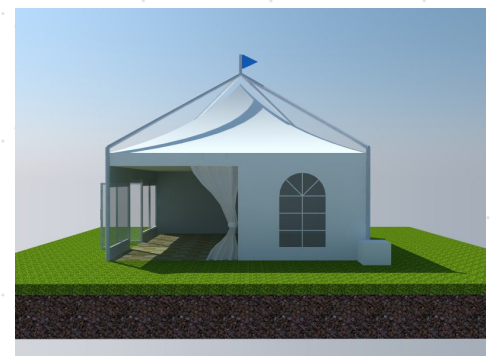
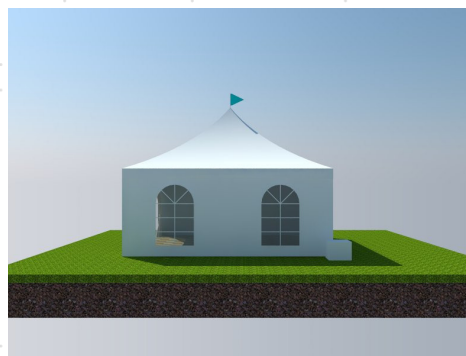
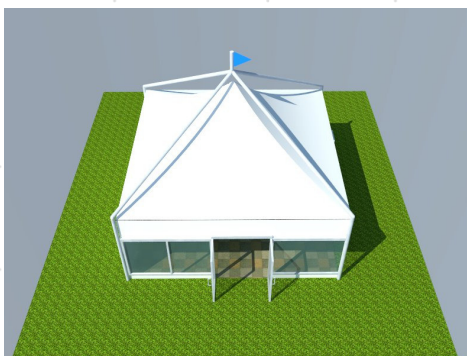

ARCUM TENT



Tent Details :

The Arcum Tent is composed of high reinforced aluminum frame and PVC covers. Arcum tent is based on the “A” frame clear span tent design and reasonably absorbs the Chinese traditional architectural design elements. We pre-press the aluminum roof-beams so that it can become the curve shape. The characteristics of the Arcum Tent will include a good-looking structure with a beautiful roof line and a lot of space inside the tent. It will also give you a feeling of currency to use it for big tents, exhibitions, or for a temporary showroom. Arcum tent is manufactured by white PVC coated material.

Material and Fabrication

- Aluminum Alloy Main Profile,
- PVC Roof Cover & PVC Clear Roof Cover
- Ground Anchors
- PVC Sidewalls & PVC Window sidewall
- Lining & Curtains
- Double Wing Glass Door / Sliding Door
- Rain Gutters
- Decoration ceilings and Inside curtain
- Glass Walls
- Weight Plates
- Floor System & Ramp for Glass Doors
- Flat ABS Walls & Shaped ABS Walls
- Fire Door
- Clear PVC Gable Wall
- Horizontal Glass Wall
- **PVC:** 0.46mm thickness PVC, 580 - 900 GSM Fire retardant to DIN 4102 B1, M2, Water proof, UV protection

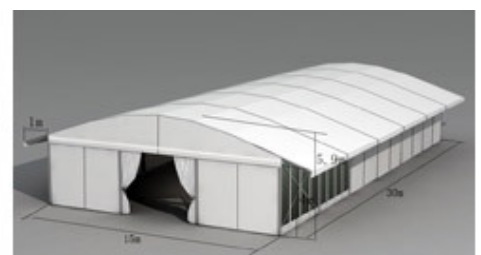
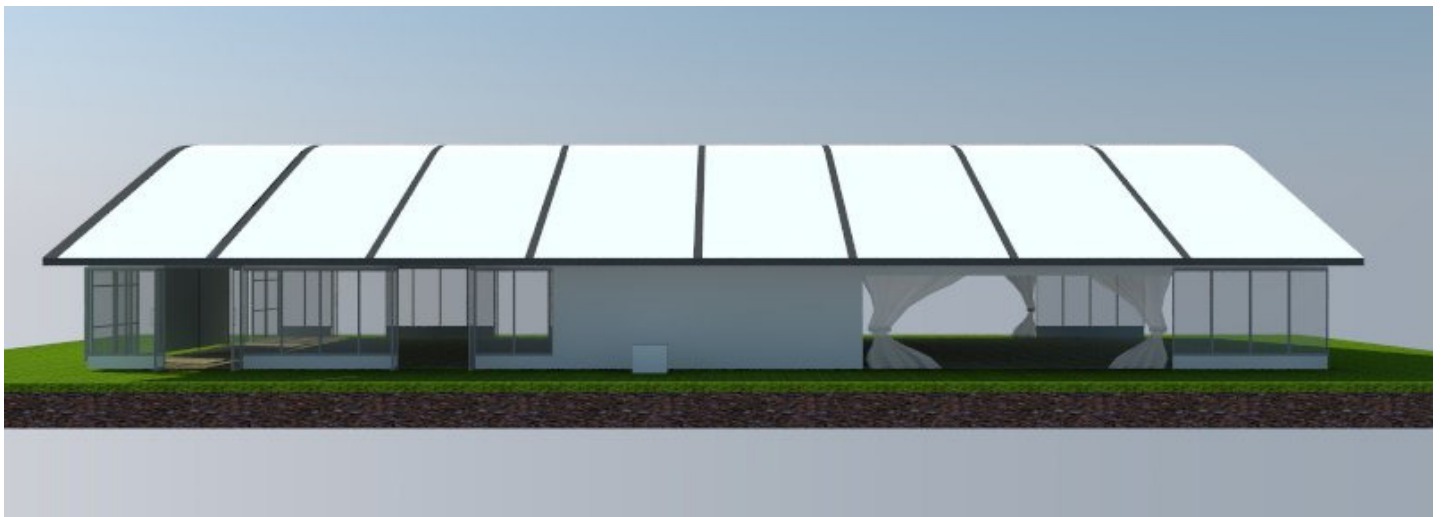

ARCUM TENT

Tent Size

Span Width	Eave Height	Ridge Height	Bay Distance	Main Profile
15m / 20m / 25m / 30m /	3.92m	5.55m / 6.33m / 7.15m / 7.87m /	5m	256 x 121 x 5mm (4 - Channel)

Span Width	Eave Height	Ridge Height	Bay Distance	Main Profile
15m / 20m / 25m / 30m / 40m	3.92m	5.4m / 6.3m / 7.15m / 7.87m / 9.6m	5m	256 x 121 x 5mm (4 - Channel)

Width	
	3m 4m 5m 5.5m 6m 7.5m 8m 9m 10m 12m 15m 16m 18m 20m 21m 25m 30m 35m 40m 45m 50m 55m 60m

Height	
	2.3m 2.4m 2.5m 2.6m 3.0m 3.3m 4.0m 5.0m 6.0m



POLYGON TENT



Tent Details :

The roof beams of the Polygon Top Tent are combined by several split aluminum alloy beams and in polygon shape, so it is named Polygon Top Tent. The standard side height of 10-40m span width tents is 4m, and 5m for 50m and 60m. The features of Polygon Top Tent: modular system, easily to be assembled and dismantled, durable, wind resistance can reach 100-120km/hour, flame retardant with relevant certificates. It is suitable for large-scale concerts, exhibitions, big parties, sport events and so on.

Material and Fabrication

- Aluminum Alloy Main Profile,
- PVC Roof Cover & PVC Clear Roof Cover
- Ground Anchors
- PVC Sidewalls & PVC Window sidewall
- Lining & Curtains
- Double Wing Glass Door / Sliding Door
- Rain Gutters
- Decoration ceilings and Inside curtain
- Glass Walls
- Weight Plates
- Floor System & Ramp for Glass Doors
- Flat ABS Walls & Shaped ABS Walls
- Fire Door
- Clear PVC Gable Wall
- Horizontal Glass Wall
- **PVC:** 0.46mm thickness PVC, 580 - 900 GSM Fire retardant to DIN 4102 B1, M2, Water proof, UV protection

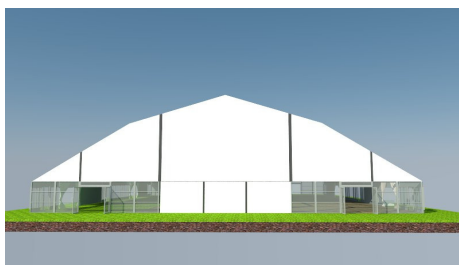

POLYGON TENT

Tent Size

Span Width	Eave Height	Ridge Height	Bay Distance	Main Profile
10m / 12m / 15m / 18m / 20m / 25m / 30m / 40m / 50m / 60m	4m	7.16m / 7.m / 8.75m / 9.15m / 9.42m / 11.72m / 13.2m / 15.6m / 16m / 18m	5m	10-20m : 204x120x4mm 25-30m : 256x121x5mm 40m : 300x120x5mm 50 - 60m : 400x120x7mm

Width	Width Options
Width	3m 4m 5m 5.5m 6m 7.5m 8m 9m 10m 12m 15m 16m 18m 20m 21m 25m 30m 35m 40m 45m 50m 55m 60m

Height	Height Options
Height	2.3m 2.4m 2.5m 2.6m 3.0m 3.3m 4.0m 5.0m 6.0m

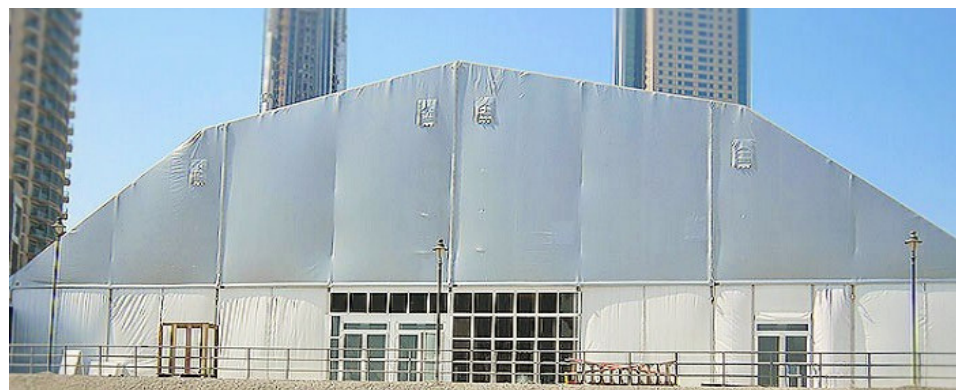
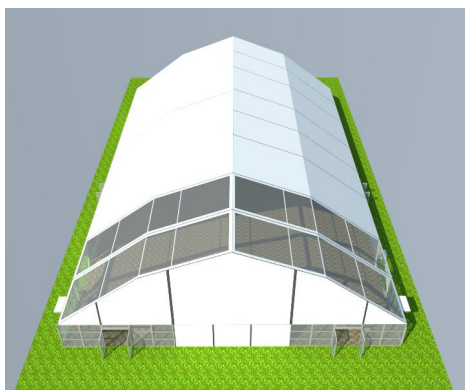

A-SHAPE TENT



Tent Details :

The A-shape tents are the ideal solution in different occasions like backyard gathering, Christmas celebration, wedding ceremony, birthday party, annual banquet and music festival. We have designed many custom tents for special festivals like beer festival, lights festival, music carnival and many more. The party marquees are available in different sizes and shapes. Its inside provide 100% interior space so that you can design and decorate it according to your need of occasion. The span can be optional from 3 - 60m in clear span design. And the length can be increased or decreased flexibly by 5m / 3m bay distance in each unit.

Material and Fabrication

- Aluminum Alloy Main Profile,
- PVC Roof Cover & PVC Clear Roof Cover
- Ground Anchors
- PVC Sidewalls & PVC Window sidewall
- Lining & Curtains
- Double Wing Glass Door / Sliding Door
- Rain Gutters
- Decoration ceilings and Inside curtain
- Glass Walls
- Weight Plates
- Floor System & Ramp for Glass Doors
- Flat ABS Walls & Shaped ABS Walls
- Fire Door
- Clear PVC Gable Wall
- Horizontal Glass Wall
- **PVC:** 0.46mm thickness PVC, 580 - 900 GSM Fire retardant to DIN 4102 B1, M2, Water proof, UV protection



MULTI-SIDE TENT



Tent Details :

Multi-side tent round tent series has a unique diamond roof and high peak roof designs. Clear span width has a wide range from 6m - 35m, Full line accessories are compatible for this series. Multi-side units are able to be joint with the regular A shape units, high peak unit to form a mixed tent. Widely used as the hotel tent, restaurant, canteen, VIP lounge, wedding, party, event and so on.

Material and Fabrication

- Aluminum Alloy Main Profile,
- PVC Roof Cover , PVC Sidewalls & PVC Window sidewall
- Lining & Curtains
- Double Wing Glass Door / Sliding Door
- Decoration ceilings and Inside curtain
- Weight Plates
- Flat ABS Walls & Shaped ABS Walls
- PVC: 0.46mm thickness PVC, 580 - 900 GSM
Fire retardant to DIN 4102 B1, M2, Water proof, UV protection



Tent Size

Span Width	Eave Height	Ridge Height	Side Length	Main Profile
Hexagonal				
6m / 8m / 9m / 10m	2.6m	3.71m / 4.18m / 4.24m / 4.4m	3m / 4m / 4.5m / 5m	100x48x3mm (4-Channels)
Octagonal				
15m / 20m	3.88m	6.3m / 7.1m	5.74m / 7.68m	204x120x4mm (4-Channels)

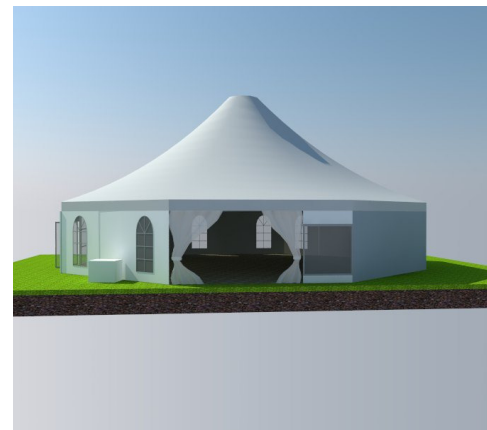
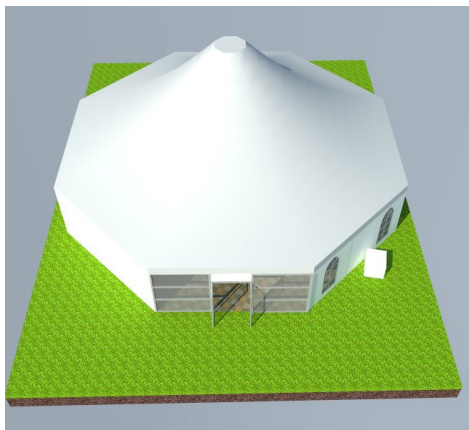
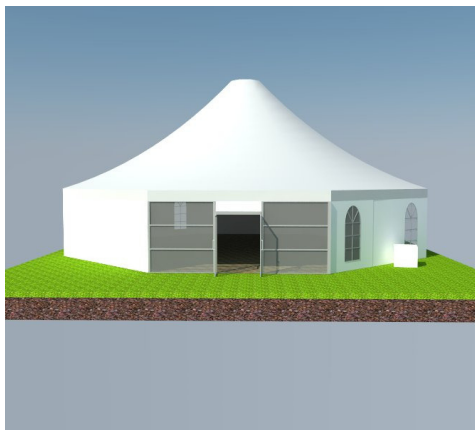

CURVE TENT



Tent Details :

Curve Tent is not only strong, but also durable, the wind retardancy can reach 100km/h(0.5kn/m²). Curve Tent can be flexibly removed and expanded with its modular structure, it is easily assembled and dismantled, storage volume is small. It can be applied in many temporary events as well as the Big Tent series, also it's a good choice as permanent building. Due to the bended aluminum roof beams and perfect roof cover tensioning system, the wind resistance and snow loading capability are stronger.

Material and Fabrication

- Aluminum Alloy Main Profile,
- PVC Roof Cover & PVC Clear Roof Cover
- Ground Anchors
- PVC Sidewalls & PVC Window sidewall
- Lining & Curtains
- Double Wing Glass Door / Sliding Door
- Rain Gutters
- Decoration ceilings and Inside curtain
- Glass Walls
- Weight Plates
- Floor System & Ramp for Glass Doors
- Flat ABS Walls & Shaped ABS Walls
- Fire Door
- Clear PVC Gable Wall
- Horizontal Glass Wall
- **PVC:** 0.46mm thickness PVC, 580 - 900 GSM Fire retardant to DIN 4102 B1, M2, Water proof, UV protection



Tent Size

Span Width	Eave Height	Ridge Height	Bay Distance	Main Profile
15m / 20m / 25m / 30m /	3.92m	5.55m / 6.33m / 7.15m / 7.87m	5m	256 x 121 x 5mm (4 - Channel)
20m / 25m / 30m / 40m	3.89m	8.9m / 10m / 11.2m / 13.5m	5m	300x120x5mm (4 Channels)

HIGH PEAK TENT



Tent Details :

High Peak tent series is always an eye-catching structure because of its bell-shaped roof line. Clear span width this tent series has a wide range from 6m to 40m. High Peak unit is able to join with regular A-shape unit, and multi-side unit to form a mixed tent. When it comes to be hotel, restaurant, or something needs to be outstanding, high peak tent would be an ideal choice.

Material and Fabrication

- Aluminum Alloy Main Profile,
- PVC Roof Cover & PVC Clear Roof Cover
- Ground Anchors
- PVC Sidewalls & PVC Window sidewall
- Lining & Curtains
- Double Wing Glass Door / Sliding Door
- Rain Gutters
- Decoration ceilings and Inside curtain
- Glass Walls
- Weight Plates
- Floor System & Ramp for Glass Doors
- Flat ABS Walls & Shaped ABS Walls
- Fire Door
- Clear PVC Gable Wall
- Horizontal Glass Wall
- **PVC:** 0.46mm thickness PVC, 580 - 900 GSM Fire retardant to DIN 4102 B1, M2, Water proof, UV protection



Tent Size

Span Width	Eave Height	Ridge Height	Peak	Bay Distance	Main Profile
6m / 8m / 9m / 10m / 12m /	2.6m	3.71m / 4.05m / 4.24m / 4.4m / 4.76m	5.18m / 5.66m / 5.83m / 6m / 6.55m	3m	100x48x3mm (4 - Channel)
15m / 20m / 25m	3.88m	7.1m / 7.88m / 7.9m	10.5m /11.43m/ 11.5m	5m	204x120x4mm (4 Channels)
30m /40m	5m	9.88m / 11.48m	13.68m / 15.2m	5m	30x120x5mm (4 Channel)

WEDDING TENT



Tent Details :

Wedding marquee tent is very flexible, it's possible for all kinds of shape: long, square, Marcum, half sphere etc. And it could be romantic, classic or themed. We have full set tent accessories and ancillary equipment to tailor a tent interior to suit your wedding, and you can also decorate the tent in the way you want. As a manufacturer, we've been committed to providing quality tents at best prices. We provide a comprehensive manufacturing and selling service for all wedding marquee tents.

Material and Fabrication

- Aluminum Alloy Main Profile,
- PVC Roof Cover & PVC Clear Roof Cover
- Ground Anchors
- PVC Sidewalls & PVC Window sidewall
- Lining & Curtains
- Double Wing Glass Door / Sliding Door
- Rain Gutters
- Decoration ceilings and Inside curtain
- Glass Walls
- PVC: 0.46mm thickness PVC, 580 - 900 GSM
Fire retardant to DIN 4102 B1, M2, Water proof, UV protection
- Weight Plates
- Floor System & Ramp for Glass Doors
- Flat ABS Walls & Shaped ABS Walls
- Fire Door
- Clear PVC Gable Wall
- Horizontal Glass Wall
- Wedding Lightings & chandelier.
- Wedding Tables (Round & Square)
- Wedding Chairs
- Wedding Stages
- Air Conditioner
- Wedding Entrances

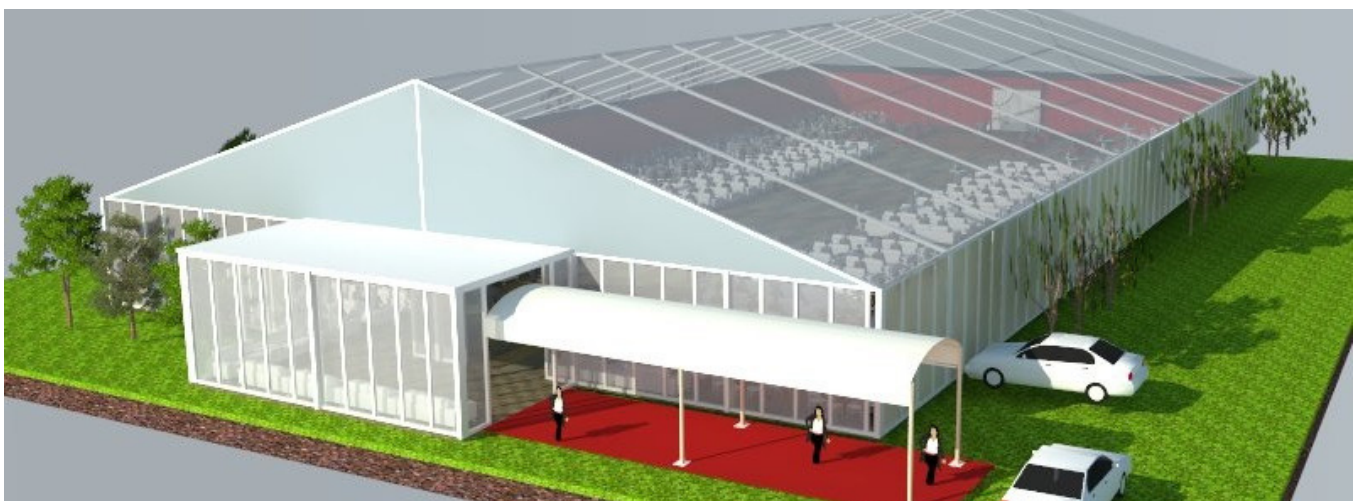

WEDDING TENT

Tent Size

Tent Size	Square ft Provided
10x10	100 sq ft
15x15	225 sq ft
20x20	400 sq ft
20x30	600 sq ft
20x40	800 sq ft
30x30	900 sq ft
30x40	1200 sq ft
30x45	1350 sq ft

Tent Size	Square ft Provided
30x50	1500 sq ft
40x40	1600 sq ft
30x60	1800 sq ft
30x70	2100 sq ft
30x80	2400 sq ft
40x60	2400 sq ft
40x80	3200 sq ft
40x100	4000 sq ft



WAREHOUSE TENT



Tent Details :

Our warehouse tents for the convenience of construction enterprises short season, the venue provides a flexible distribution of flexible space, avoiding the need to increase the production of space rental, remote working and other hidden costs. Warehouse Tent construction does not require a permanent foundation which can be built in almost any ground ---- asphalt, concrete or grass, and so on. Tents in flexibility and economy is far superior to conventional steel structures, construction of buildings and do not have the required land permits trouble. Because of the basic conditions require less, cost is also low, so its maintenance is simple and inexpensive.

Material and Fabrication

- Aluminum Alloy Main Profile,
- PVC Roof Cover & Inflatable Thermal Insulation Roof
- PVC Gable & Inflatable Thermal Gable
- PVC Sidewalls, Sandwich Panel & Steel Sheet wall
- Sliding Window
- Man Door
- Manual / Auto Rolling Door
- Weight Plates
- PVC: 0.46mm thickness PVC, 580 - 900 GSM Fire retardant to DIN 4102 B1, M2, Water proof, UV protection

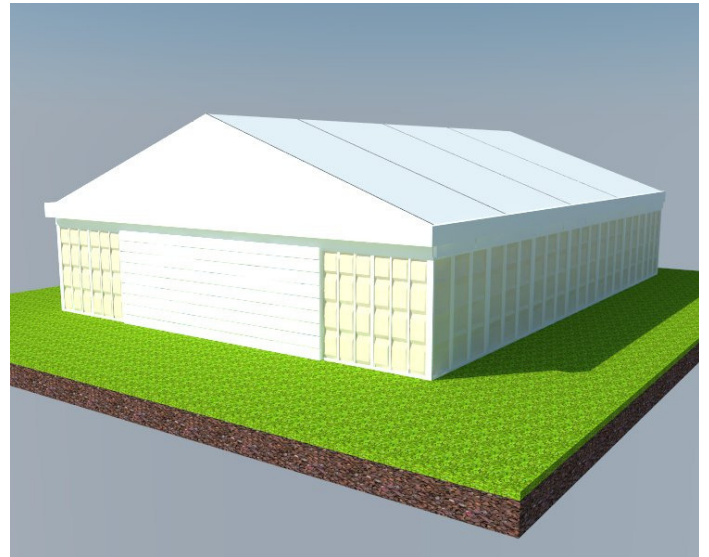

Span Width	Eave Height	Ridge Height	Bay Distance	Main Profile
5m / 7.5m / 10m / 12m	4.2m	5.05m / 5.46m / 5.84m / 6.16m	5m	204x120x4mm (4 Channels)
20m / 25m / 30m	5.2m	8.4m / 9.2 m / 10m	5m	350x120x5mm (4 Channels)

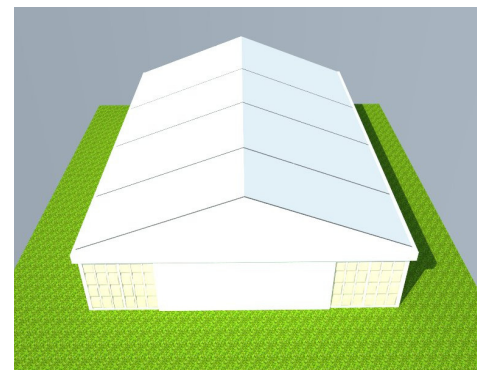

DOME TENT



Tent Details :

The dome tent is advanced, safe, and reliable, which can resist 80 km/hr wind speed. It is an ideal solution of walkway passage.

The performance of the unique and innovative dome tent is quite outstanding, the features are as following: Can absorb sunlight effectively and slow down the heat loss. Can resist harsh climatic conditions. This kind of small aluminum dome tent is easy to set up and dismantle. Very popular used for outdoor product show, private gatherings and parties.

Material and Fabrication

- Aluminum Alloy Main Profile,
- PVC Roof Cover & Clear PVC roof cover
- PVC Gable & Clear PVC Gable
- PVC Sidewalls, Clear PVC Sidewall
- PVC Window Sidewall
- Flat ABS walls
- Double Wing Glass Door, Sliding door
- Floor System
- Decoration Ceilings, Lining and Curtains
- Weight Plates
- PVC: 0.46mm thickness PVC, 580 - 900 GSM Fire retardant to DIN 4102 B1, M2, Water proof, UV protection



Span Width	Eave Height	Ridge Height	Bay Distance	Main Profile
3m / 4m / 5m / 6m 8m	2.6m	3.0m / 3.2m / 3.4m / 3.6m / 4.0m	3m	71x36x2.5m m (4 Channels)



MILITARY TENT



Tent Details :

The military tent are not only used by the military but can also serve as a disaster relief station. The clear span design provide 100% interior space usable. It can be assembled and dismantled easily, has small transportation size, can resists wind load. PVC are made by durable and flame retardant material. The mesh window is also a good idea to provide comfort even on perilous place.

Material and Fabrication

Aluminum Alloy Main Profile, PVC Roof Cover, Ground Anchors, Sidewalls with PVC Fabric, Lining Curtains, Roll up Door and Window, PVC Window and Mesh Window, and Floor system.

Specifications of Roof & Side wall:

PVC: 0.46mm thickness PVC, 580 - 900 GSM, Fire retardant to DIN 4102 B1, M2, Water proof, UV protection

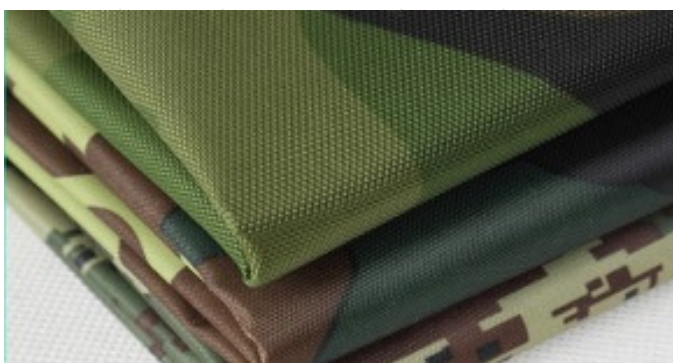
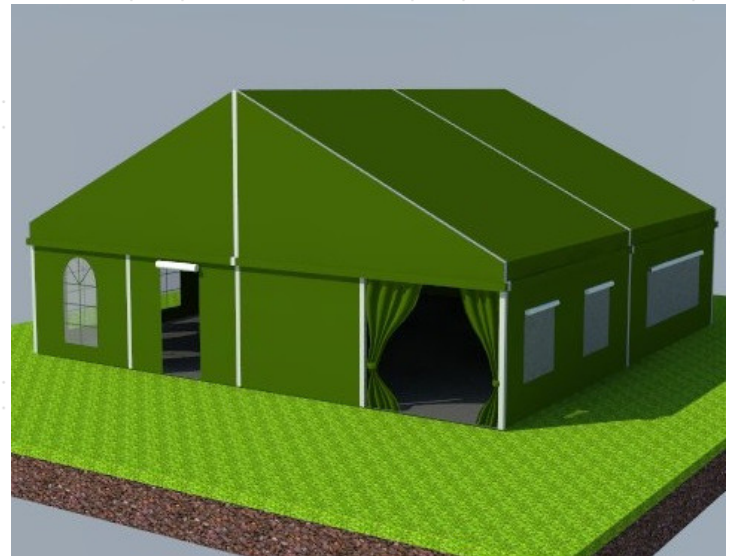

Tent Size

Sizes range from 3m X 3m, 4m X 4m, 5m X 5m, 6m X 6m, 8m X 8m, 10m X 10m, and can be modify as per request or need of the client.



CUBE STRUCTURE TENT



Tent Details :

The military tent are not only used by the military but can also serve as a disaster relief station. The clear span design provide 100% interior space usable. It can be assembled and dismantled easily, has small transportation size, can resists wind load. PVC are made by durable and flame retardant material. The mesh window is also a good idea to provide comfort even on perilous place.

Material and Fabrication

- Aluminum Alloy Main Profile,
- PVC Roof Cover & PVC Clear Roof Cover
- Thermal Insulation Roof Tent
- Ground Anchors
- PVC Sidewalls & PVC Window sidewall
- Advertisement Position Location
- Double Wing Glass Door / Sliding Door
- Decoration ceilings, Lining and Inside curtain
- Glass Walls
- Weight Plates
- Floor System & Ramp for Glass Doors
- Flat ABS Walls & Shaped ABS Walls
- Fire Door
- Clear PVC Gable Wall
- Horizontal Glass Wall
- **PVC:** 0.46mm thickness PVC, 580 - 900 GSM Fire retardant to DIN 4102 B1, M2, Water proof, UV protection

Span Width	Eave Height	Ridge Height	Bay Distance	Main Profile
10m / 15m / 20m / 25m / 30m	5m	5.58m / 5.89m / 6.2 m / 6.5m / 6.8m	5m	(10m) 204x120x4mm (15m-20m) 256x121x5mm (30m) 300x120x5mm (4-Channel)

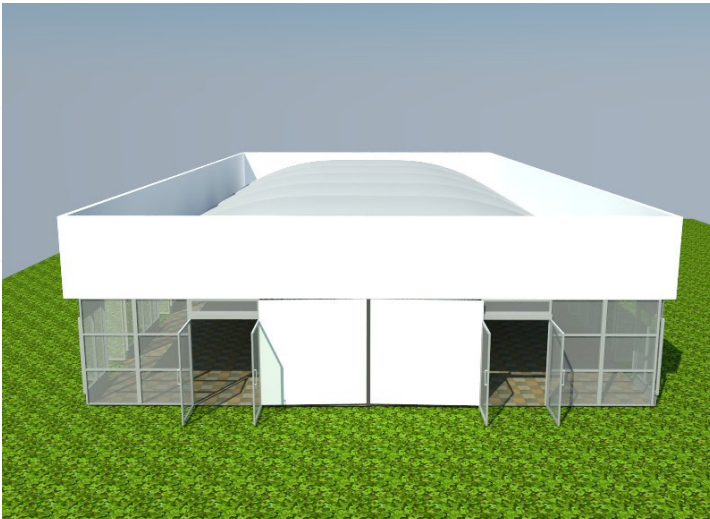

STEEL STRUCTURE TENT

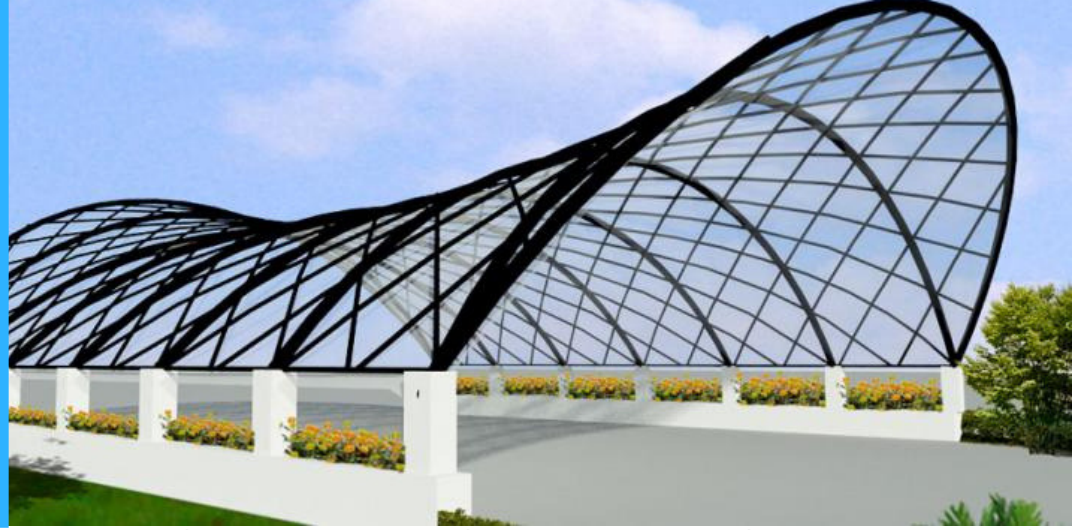

Tent Details :

Steel Structure Tent is Widely used for private & corporate party, celebration, outdoor exhibition & Expo , trade show, commercial activity, sports events, temporary warehouse & workshop, military, relief & emergency solution, semi-permanent or permanent industry facility, entertainment space, etc. We tarp is waterproof fire of PVC material, rainy weather can be used even in the water will not flow into the inner tent. Independent house structure, shape looks nice, like a little house to move, galvanized iron pipe brackets to support, stable and durable. And unlimited space and can be installed in small private courtyard garden. Grass, cement and so can.

Material and Fabrication

Frame struss: hard pressed extruded steel.

Fabric cover: high quality double PVC-coated polyester textile, 100% waterproof, flame retardant to DIN 4102 B1, M2, CFM, UV resistant, tear resistant, self-cleaning ability, etc.

Connector: strong hot-dip galvanized steel.

Allowed temperature condition: -30 degree Celsius~+70 degree Celsius

Wind load: max. 100 km/h (can be reinforced)

Snow load: 75 kg/sqm (snow can't stay if use big degree roof pitch design)

Easy to be assembled and dismantled, movable.

No pole inside, 100% available interior space.

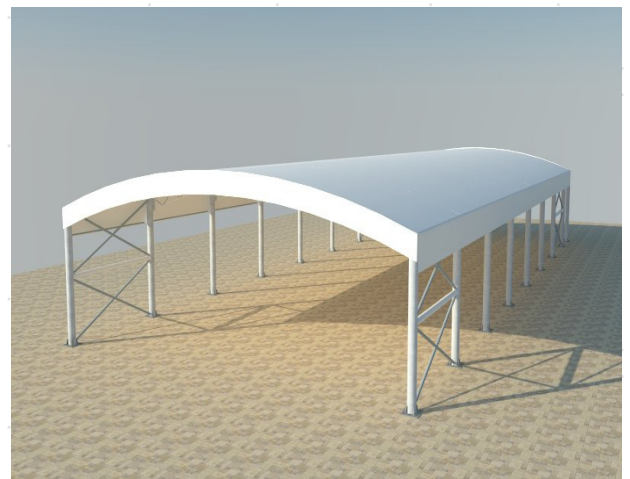
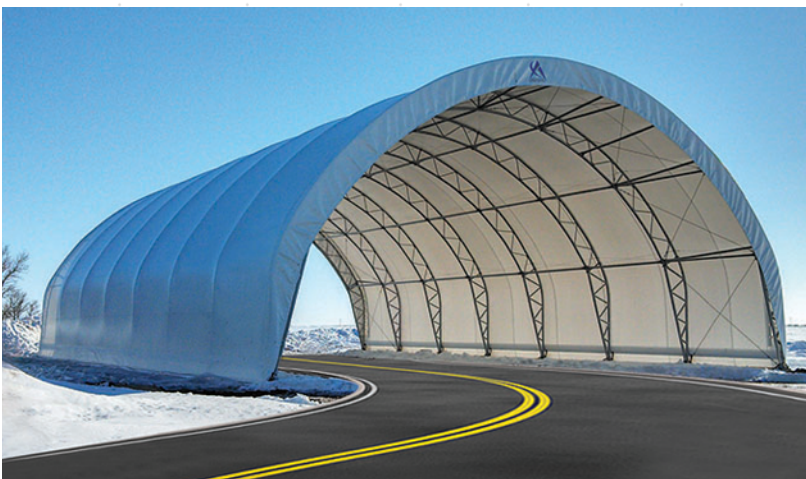



AL KHAYAM AL ARABIAH TENTS & SHEDS TRD LLC

Office No 701, 7th Floor AirIndia Express Building Al Soor, Sharjah UAE

Mob: +971 506975093

Office: +971 65540402

Email: info@akaatent.com

Web: www.akaatent.com

GROUP OF COMPANIES:

AL-FAQEER EVENTS LLC

Mob: +971 506975093

Office: +971 65540402

Shed No 1, Zhaid Rd Bridge 7

New Industrial Area, Sharjah UAE

AL-FAQEER TENTS & SHEDS

Phone: +971 557241552

Office No 103, 1st Floor

Air India Express Building

Al Soor, Sharjah UAE

EMPIRE MARQUEE

Phone: +92323 3333300

Office No 1113, 11th Floor

Eden Heights Building

Jail Road, Lahore Pakistan